

Digital Application Sheet

OPTARE

VEHICLE MANUFACTURER	OPTARE BUS
MODEL	COACHES
YEAR OF MANUFACTURE	2005—
ENGINE TYPE	DAIMLER DIESEL
TRANSMISSION	ALL
VOLTAGE	24V



STONERIDGE DIGITAL KIT FOR THIS VEHICLE: 7800-071

PARTS LIST	QUANTITY	STONERIDGE PART NO.
SE5000 TACHOGRAPH	1	
HINO 300 TACHOMOTION KIT	1	
SENDER	1	
SENDER CABLE	1	
SHROUD SEALING KIT	1	
DRIVER QUICKGUIDE	1	102022P/01
INSTALLATION KIT	1	
APPLICATION SHEET	1	6800-334

ADDITIONAL VEHICLE MANUFACTURERS PARTS REQUIRED	VEHICLE MANUFACTURERS PART NO.
Wiring schematic	Digital tachograph for Euro 3.
Gearbox bracket drawing.	Drawing No.R4600086

A KRM series SE5000 programmed using the SE5000 Configuration System can also be used in this vehicle.

To configure the SE5000 KRM using the SE5000CS, select the COACH 2005-ON icon within the OPTARE manufacturer type.

Ensure 2nd Source of motion is set to C3 Enabled and C3 Speed Factor is set correctly within Sensor Test within MKIII Programmer on Optimo.

FITTING INFORMATION



Modify the gearbox bracket as shown in drawing R4600086

Install new sender unit.

Run sender cable.

Prepare dash to fit tachograph.

WIRING.

Yellow plug of the new sender cable goes to the tach.

'Piggy back' off the white power plug of the dash loom to provide a white plug for the tach.

Connect a wire from tach B7 to Speedometer B3 as in the wiring diagram.

Workshop Technical Support

Tel +44 (0) 1382 866 400 (choose opt.2. opt.1)

Fax +44 (0) 1382 866 401

Sales Office

Tel +44 (0) 1382 866 400 (choose opt.1)

Fax +44 (0) 1382 866 401



Whilst we have endeavoured to ensure the accuracy of the information supplied, Stoneridge Electronics cannot be held responsible for any errors or omissions. It is the installer's responsibility to ensure compliance with specific vehicle manufacturers repair procedures, especially with regard to the procedure for disconnection/reconnection of the battery. Failure to comply with the vehicle manufacturers instructions may result in personal injury and/or component damage/data loss.

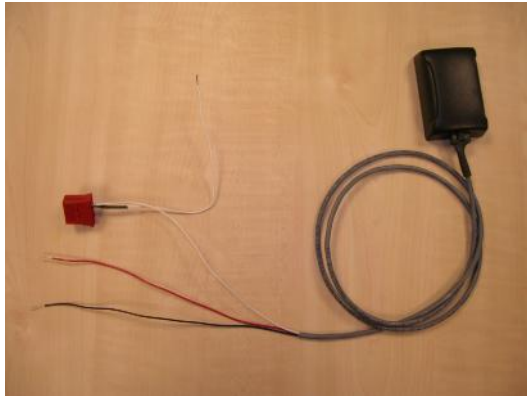

1. Connect the RED wire from the GPS Tachomotion kit to **12V ONLY**. The 12V supply can be taken from the 12V Auxiliary Supply.
2. Connect the BLACK wire from the GPS Tachomotion kit to GND. The GND can also be taken from the Auxiliary Supply.

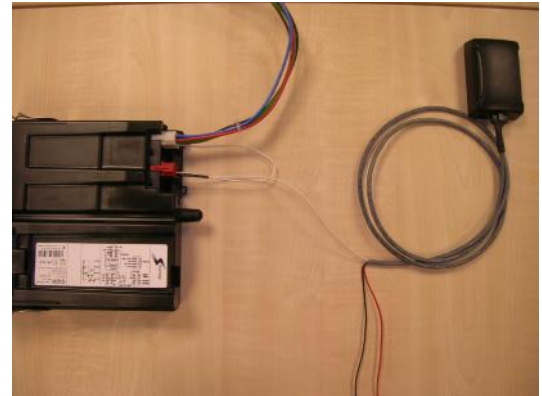

3. Connect the free WHITE wire from the Red C Plug (Position C3) to the wire located in position A3 on the White A plug that connects to the tachograph.

Workshop Technical Support

Tel +44 (0) 1382 866 400 (choose opt.2. opt.1)

Fax +44 (0) 1382 866 401

Sales Office

Tel +44 (0) 1382 866 400 (choose opt.1)

Fax +44 (0) 1382 866 401



Whilst we have endeavoured to ensure the accuracy of the information supplied, Stoneridge Electronics cannot be held responsible for any errors or omissions. It is the installer's responsibility to ensure compliance with specific vehicle manufacturers repair procedures, especially with regard to the procedure for disconnection/reconnection of the battery. Failure to comply with the vehicle manufacturers instructions may result in personal injury and/or component damage/data loss.

ACHOGRAPH
CONNECTOR A
WAY PLUG
50-23-9510
TERMINALS
25596-1

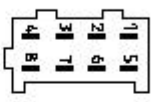

ACHOGRAPH
CONNECTOR B
WAY PLUG
50-23-9520
TERMINALS
25596-1

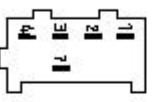

SPEEDOMETER
WHITE 8WAY PLUG
AMP PART NO
927365-1
TERMINALS
925596-1

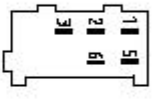

SPEEDOMETER
YELLOW 8WAY PLUG
AMP PART NO
927366-1
TERMINALS
925596-1

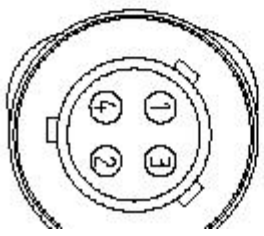
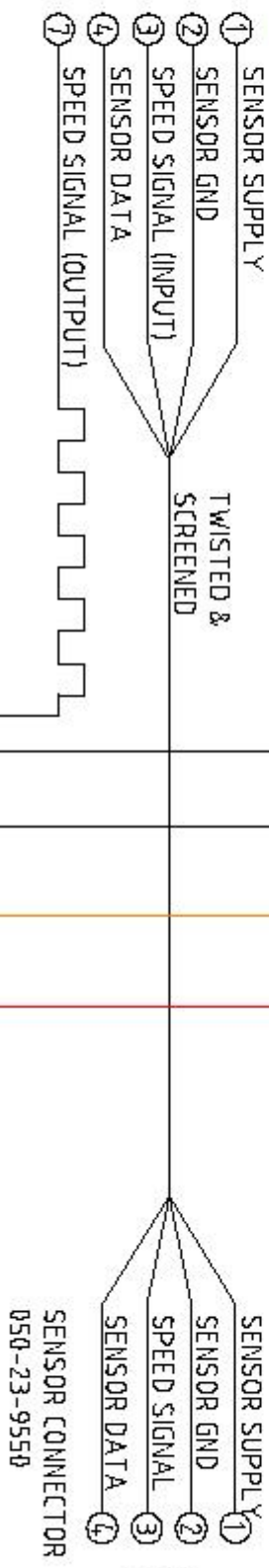
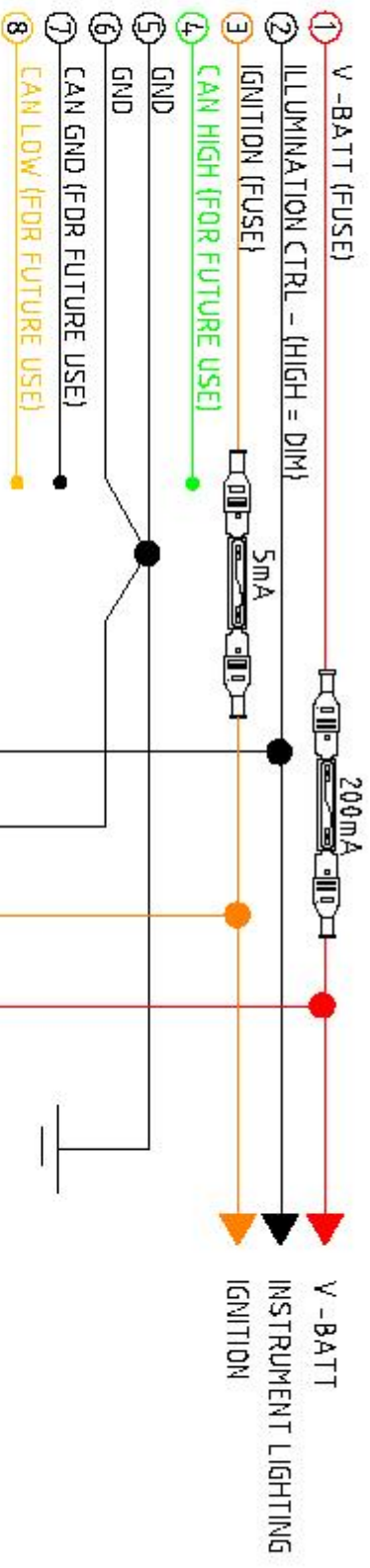
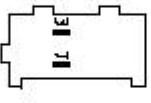

SPEED SIGNAL
GENERATOR
(8 PULSES PER
REVOLUTION)

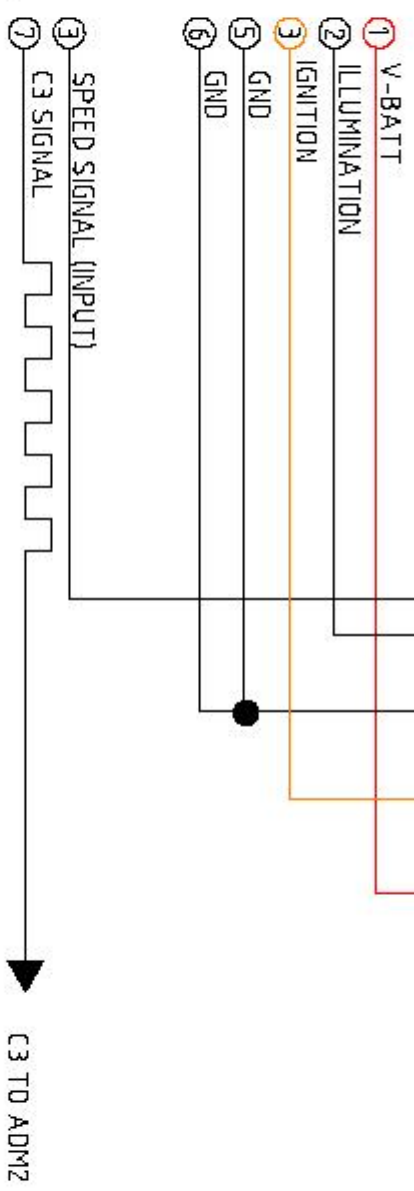

DP

06/02/06

SCALE

3RD ANGLE
PROJECTION

CONFIDENTIAL

THIS DRAWING AND THE INFORMATION CONTAINED HEREIN ARE THE PROPERTY OF OPTARE LTD. NO PART OF THIS DRAWING, IN ANY FORM, MAY BE REPRODUCED OR TRANSMITTED IN ANY FORM OR BY ANY MEANS, WITHOUT PERMISSION IN WRITING FROM OPTARE LTD.

TOLERANCES									
UNLESS OTHERWISE STATED									
D	120	315	1000	1500	3000	C	ISS	EC No	DATE
120	315	1000	1500	3000	1200	D	A		
±0.5	±1.0	±1.5	±2.0	±2.5	±5	E			
±0.2	±0.5	±1.0	±1.25	±2.5	±5	F			
±0.1	±0.2	±0.5	±1.0	±1.25	±5	G			

TITLE:

DIGITAL TACHOGRAPH EURO 3

DR04WIKS.Hu.

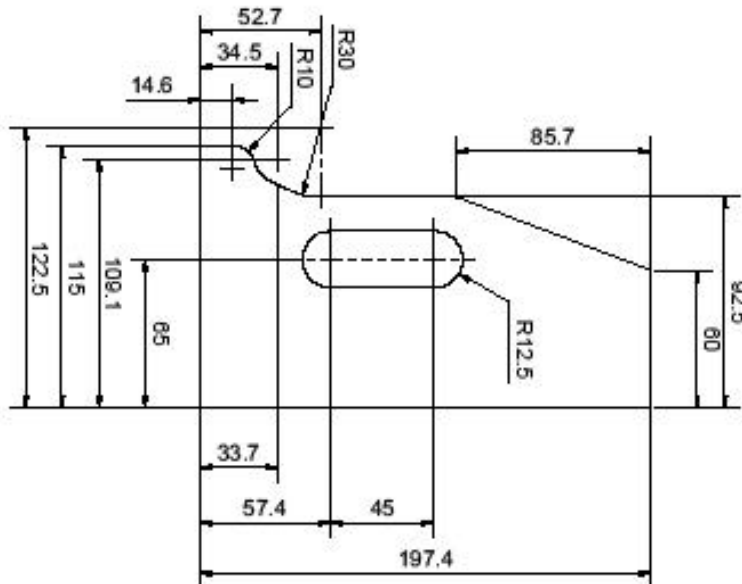
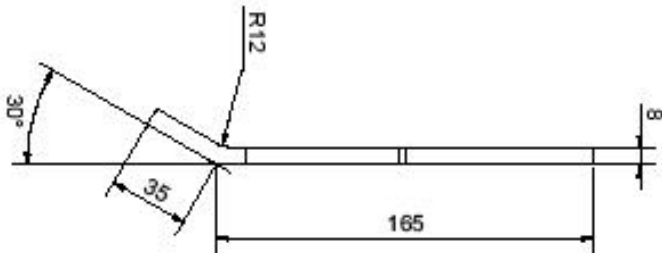
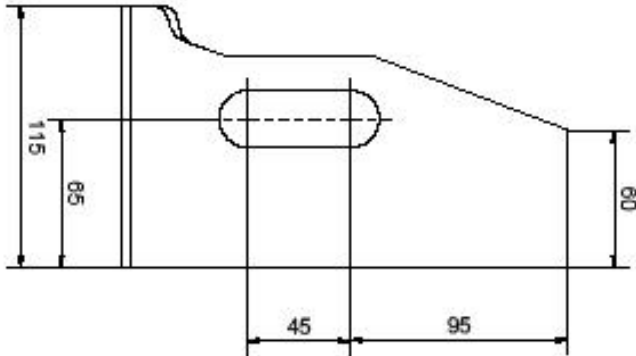
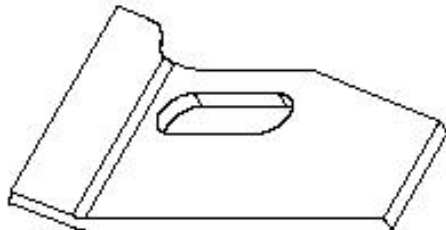

DRAWN	BRIAN BEEBLE	SCALE	1/2	3RD ANGLE PROJECTION	CONFIDENTIAL	TOLERANCES	ISO E.C. No.	DATE	TITLE
DATE	26/09/2000				THE INFORMATION CONTAINED HEREIN IS UNCLASSIFIED AND IS NOT TO BE RELEASED OR DISCLOSED TO THE PUBLIC OR TO ANY OTHER PERSON OR ENTITY WITHOUT THE EXPRESS WRITTEN PERMISSION OF THE COMPANY.	ON DIMS UNLESS OTHERWISE STATED	A. 100000	1/20/2000	SIDE PLATE LH - TRANS MTG BRKT
MAT'L	Steel, NPL Br 10 C25 S135				THIS DRAWING IS THE PROPERTY OF OPTARE AND IS NOT TO BE REPRODUCED OR TRANSMITTED IN ANY FORM OR BY ANY MEANS, ELECTRONIC OR MECHANICAL, WITHOUT THE EXPRESS WRITTEN PERMISSION OF OPTARE.		B. 100000	1/20/2000	
FINISH	Suitable for welding				THIS DRAWING IS THE PROPERTY OF OPTARE AND IS NOT TO BE REPRODUCED OR TRANSMITTED IN ANY FORM OR BY ANY MEANS, ELECTRONIC OR MECHANICAL, WITHOUT THE EXPRESS WRITTEN PERMISSION OF OPTARE.		C. 100000	1/20/2000	
CUST					THIS DRAWING IS THE PROPERTY OF OPTARE AND IS NOT TO BE REPRODUCED OR TRANSMITTED IN ANY FORM OR BY ANY MEANS, ELECTRONIC OR MECHANICAL, WITHOUT THE EXPRESS WRITTEN PERMISSION OF OPTARE.		D. 100000	1/20/2000	
TEST USED					THIS DRAWING IS THE PROPERTY OF OPTARE AND IS NOT TO BE REPRODUCED OR TRANSMITTED IN ANY FORM OR BY ANY MEANS, ELECTRONIC OR MECHANICAL, WITHOUT THE EXPRESS WRITTEN PERMISSION OF OPTARE.		E. 100000	1/20/2000	

OPTARE

DRAWING NO.
R4600086

A3
1 OF 1